

# 2.50mm (0.098") PITCH CONNECTOR



**Board-to-Board  
Wafer**

**25040HS Series**

**DIP**

**Straight**

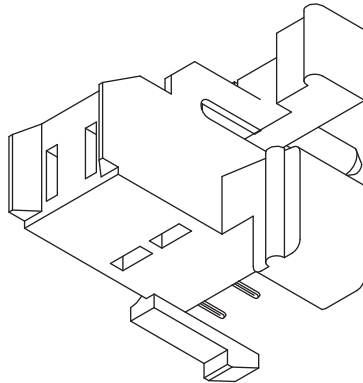

## Material

I/NO	DESCRIPTION	TITLE	MATERIAL
1	HOUSING	25040HS	PA66, UL94 V Grade
2	TERMINAL	25040TS	Phosphor Bronze & Tin-Plated

## Specification

ITEM	SPEC
Voltage Rating	AC/DC 250V
Current Rating	AC/DC 3A
Operating Temperature	-25°C~+85°C
Contact Resistance	30mΩ MAX
Withstanding Voltage	AC1000V/1min
Insulation Resistance	1000MΩ MIN
Applicable Wire	-
Applicable P.C.B	1.2mm~1.6mm
Applicable FPC/FFC	-
Solder Height	-
Crimp Tensile Strength	-
UL FILE NO	-

25040HS-02A00

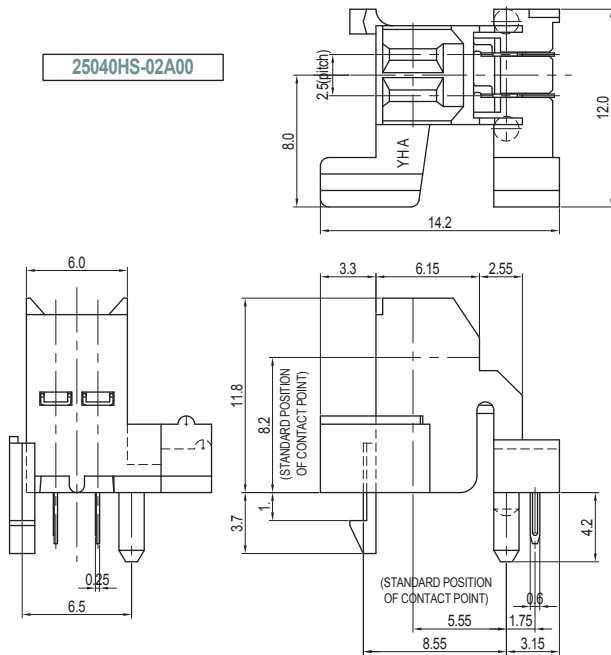

25040HS-02A01

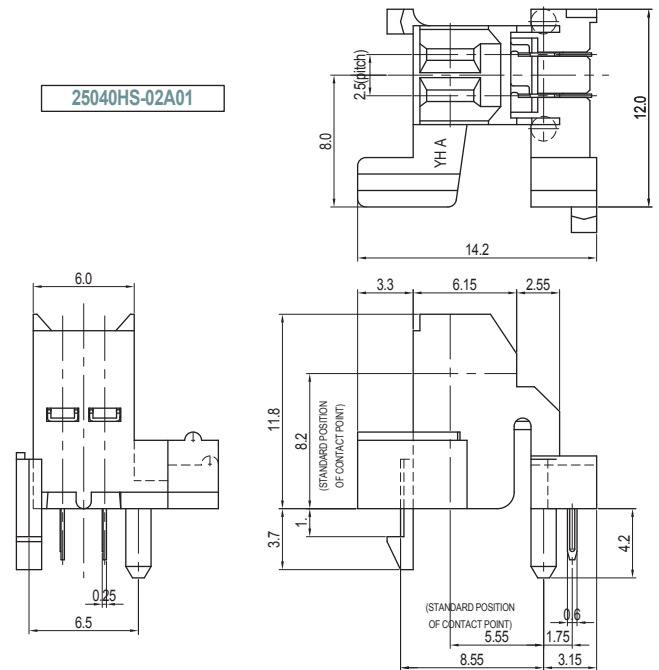

25040HS-02A00

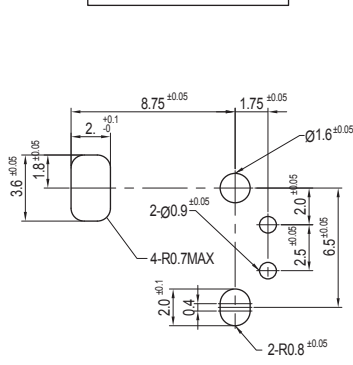

PCB-LAYOUT

25040HS-02A01

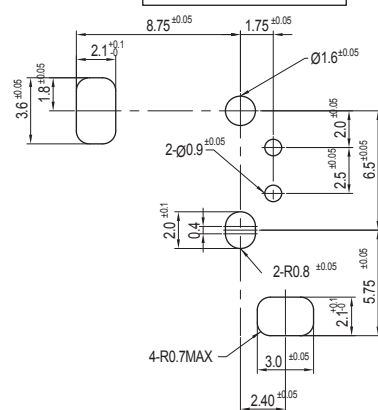

PCB-LAYOUT

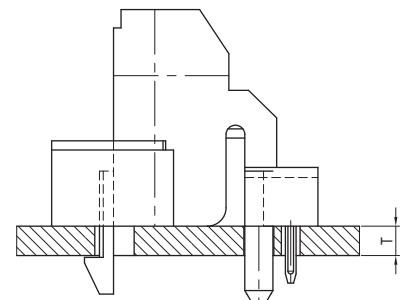

PCB ASSY